



REQUISITION FOR AUTHORITY FOR EXPENDITURE.

Form 1363 (Revised 12-30-04)

Seattle, Wash., Jan. 13 1912

Comptroller's No.

Seattle

Division. Operating

Department.

Applicant's No. 10-12

Authority is requested for an expenditure as per detailed estimate attached of \$ 1813.00

For { new work additions at Lake Washington Belt Line (Firhook) maintenance } consisting of filling part of bridge No. 18

INSTRUCTIONS

The location is shown by plan attached, sketch on back, and is on this company's property. To secure required rights, it will be necessary

Charges are to be made against H P Ry for entire cost as per

A. F. E.

The expenditure is recommended for the following reasons:

This portion of bridge 18 is in such condition that in order to safely carry the track the bridge should either be soon renewed or the opening filled. This work is already practically completed under General Manager's emergency authority, dated and this R P A is drawn to cover the cost.

2 weeks

when approved

will be required for construction, which should be commenced

in order to complete by

Division forces

Division Superintendent

and be done by

under charge of

Jan. 13 1912 (Title) Div Supt

1912 (Title) Genl Supt

1912 (Title) Div Engr

1912 (Title)

SKETCH

N.P.R.Y.  
Seattle Div 2<sup>nd</sup> District.  
M.P. 20 Belt Line.

Sketch showing Location of  
Bridge 15. To be partially filled.

Office of Div Engr. Tacoma Wash.  
Scale 1"=400'  
Dec 28 '11.

Note: 2014<sup>5</sup> yds to complete fill.  
302 " 15% shrinkage.  
2316<sup>5</sup> " Total.  
172 cu yds. Ballast.

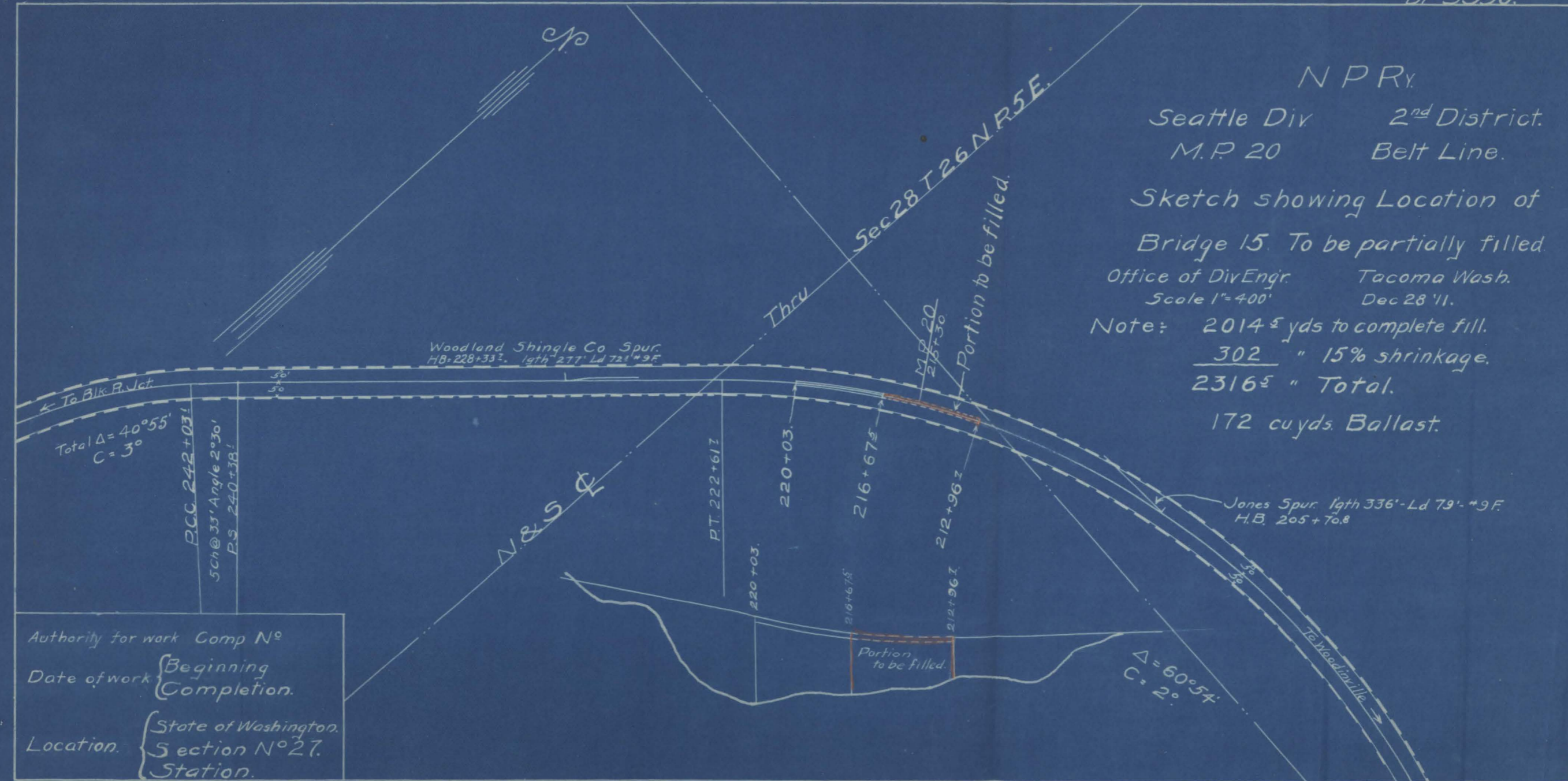

Authority for work Comp N°  
Date of work { Beginning  
                  { Completion.  
Location. { State of Washington.  
              { Section N° 27.  
              { Station.

NORTHERN PACIFIC RAILWAY COMPANY  
SEATTLE DIVISION, LAKE WASHINGTON BELT LINE  
WASHINGTON VALUATION SECTION #27  
PIRLOCK.

Estimate of cost of filling part of Bridge No. 16, which was partially filled during the construction of the line, as per sketch dated DEC 28 1911

		<u>LABOR</u>	<u>MATERIAL</u>	<u>TOTAL</u>
2500 cu. yds. gravel,	.10 ✓	250.00		250.00
Removing 30051 ft. B.M. stringers,	3.50 ✓	106.15		106.15
Raising & surfacing 317' track	.10 ✓	31.70		31.70
		<hr/>		<hr/>
		386.85		386.85
Engineering & Incidentals		39.00		39.00
Work train services		350.00		350.00
Hire of equipment				175.00
Repairs to equipment				70.00
Transportation of men				50.00
Use of track & other facilities				420.00
Overhead charges				22.36
		<hr/>		<hr/>
		\$775.85		\$1513.21

ESTIMATED VALUE OF SALVAGE:

30,000 ft. B.M. stringers, 3.00 90.00

ESTIMATED COST TO REPLACE OLD TRESTLE:

2044.00

ESTIMATED COST OF TEMPORARY TRESTLE, necessary

to have made fill in first instance, 951.00

OFFICE OF DIVISION ENGINEER  
Tacoma, Wash., Dec. 25, 1911

(Signed) B. L. Crosby  
Division Engineer.



R. F. A. No. 10

F. D. No. 8 (1912)

**AUTHORITY FOR EXPENDITURE.**

Requisition dated January 13, 1912

Comptroller's No. 162

From Seattle Division Operating Department.

For Lake Washington Belt Line, Firlock, Washington (near), - complete filling Bridge No. 18 and remove stringers.

Amount, \$1394.00

**REMARKS AND RECOMMENDATIONS.**

Work being done by Division forces

Informal authority issued by Fourth Vice-President November 7, 1911.

Bridge partially filled during October and November, 1904.

1912 Form 134 item

Washington Valuation Section No. 27.

Operating Expenses	- - -	\$ 1328.00
Additions and Betterments	Oct. No. 4-3	\$ 1920.00
	" " 4-7	\$ 2044.00
	" "	\$
Material and Supplies	- - -	\$ 90.00

*[Signature]*  
Engineer Maintenance of Way.

*[Signature]*  
Chief Engineer of Maintenance of Way.

*[Signature]*  
Chief Engr., Mech. Supt. or Supt. Trolg'ph.

*[Signature]*  
General Manager.

*[Signature]*  
Third Vice-President.

*[Signature]*  
Second Vice-President.

*Call*  
*Take up 50% each month*  
*credit to the 1st of month until the*  
*difference between the*  
*2044-1951- or 1093- is*  
*disposed of if not understood*  
*see note*

**DISTRIBUTION OF CHARGES.**

Operating Expenses	.....	1328.00
Additions and Betterments	.....	1000.00
Material and Supplies	.....	450.00
Rail Renewal Fund	.....	90.00
Total, \$		1294.00

**NORTHERN PACIFIC**  
**APR 10 1912**  
**OFFICE AUDR. DIVISION**

MAR 2 - 1912

Approved \_\_\_\_\_ 191

*[Signature]*  
Comptroller

*[Signature]*  
President

**COMPTROLLER'S RECORD OF NOTICE OF APPROVAL AND OF COMPLETION.**

Work commenced \_\_\_\_\_ Form 1345 issued APR 15 1912 191 Work Completed \_\_\_\_\_ 191

## NORTHERN PACIFIC RAILWAY COMPANY.

SEATTLE

DIVISION

H. A. Gray,

Seattle, Wash., November 13th

1912

Comptroller,

St. Paul, Minn.

Dear Sir:

I beg to advise you that work authorized by improvement, your No. 162-12 covering Firlock near, Brg 15, Fill and remove stringers was completed Febuary 1912 My record shows cost as follows:

Material,	\$
Labor,	\$ 522.87
Engineering,	\$
Contract Work,	\$
Miscel	.....430.54...
Total	\$ 953.41

Yours truly,

Superintendent.

REMARKS:

Decrease in labor account work done under favorable circumstances, material for filling received from Snohonish, at which point steam shovel was located.

No selvege as per estimate as material received was useless.

Orig G.J.M  
11-13th-1912