



NORTHERN PACIFIC RAILWAY COMPANY

AUTHORITY FOR EXPENDITURE

1958 YEAR 1958

SUPERINTENDENT'S R. F. A.

No.

1958

DEPT. NO.

ENGINEERING DEPT. NO. 49

A. F. E. NO.

191

Tacoma

Div.

Eleventh

DISTRICT  
BRANCH

STATE

Wash.

VAL. SEC. NO. 8-A

AUTHORITY IS REQUESTED FOR A NET EXPENDITURE OF \$ --

Accounting distribution as follows: (Distribution to be made in General Office.)

|   | Operating Expenses | Net Operating Expenses |
|---|--------------------|------------------------|
| Cost of property retired.....\$                                 |                    |                        |
| Value of salvage.....   |                    |                        |
| Incidental costs.....   |                    |                        |
| Total to Operating Expenses.....                                |                    |                        |
| Total to Accrued Depreciation.....                              |                    |                        |
| To Material and Supplies.....                                   |                    |                        |
| To Bills for Collection.....                                    |                    | 2,725                  |
| To Other Accounts.....  |                    |                        |
| Net charge to investment account—Additions and Betterments..... |                    |                        |
| Total of distribution.....                                      |                    | \$ 2,725               |

Budget reference: Not in Budget.

Class of Work: No. 7

Joint facility contract reference: Not Joint Account.

The location is - on this company's property. To secure rights, it will be necessary

Location: Kirkland

Title: Overhead crossing at Northeast 116th Street.

and

Reason: King County proposes to construct a bridge over the Lake Washington Belt Line main track at Northeast 116th Street in Kirkland, Washington.

This A.F.E. covers incidental work to be done by Railway Co. forces at the expense of King County in accordance with agreement dated July 15, 1957.



Work to be done by company force under charge of Division Superintendent

Accounting to concentrate in the office of District Accountant, Tacoma

Signature and Title: *McLough* Valuation Engineer

Date 3/6/58 19

APPROVED:

Date Asst. Gen'l. Manager, Date Bridge, Signal or Water Service Engineer, Date General Manager.

*C. E. Ekberg*

*J. H. Steinhilber*

APE ED NO. 49

NORTHERN PACIFIC RAILWAY COMPANY

Tacoma Division

Lake Washington Belt Line

KIRKLAND

State of Washington

Valuation Section No. 8A

Estimate of cost of work to be performed by N.P.Ry.Co. forces in connection with construction of overhead bridge, by King County, at Northeast 116th St., per sketch dated October 2, 1956, revised May 3, 1957.

Bills for Collection vs King County

|   |            |
|---|------------|
| Furnish material for & place steel guardrail  | 700        |
| Furnish material for & place two temporary telltales and remove   | 750        |
| Remove plank crossing   | 50         |
| Furnish flagmen, inspectors, etc. deemed necessary by Railway Co.'s Supt. for protection of its trains and the public while constructing piers adjacent to Railway Co.'s track & overhead structure, as well as during any other construction work on the overhead crossing which might be hazardous to Railway Co.'s operation | 1000       |
| Rearrange communication line  | 225        |
|   | <hr/> 2725 |

S U M M A R Y

Bills for Collection 2725

Not Joint Account.



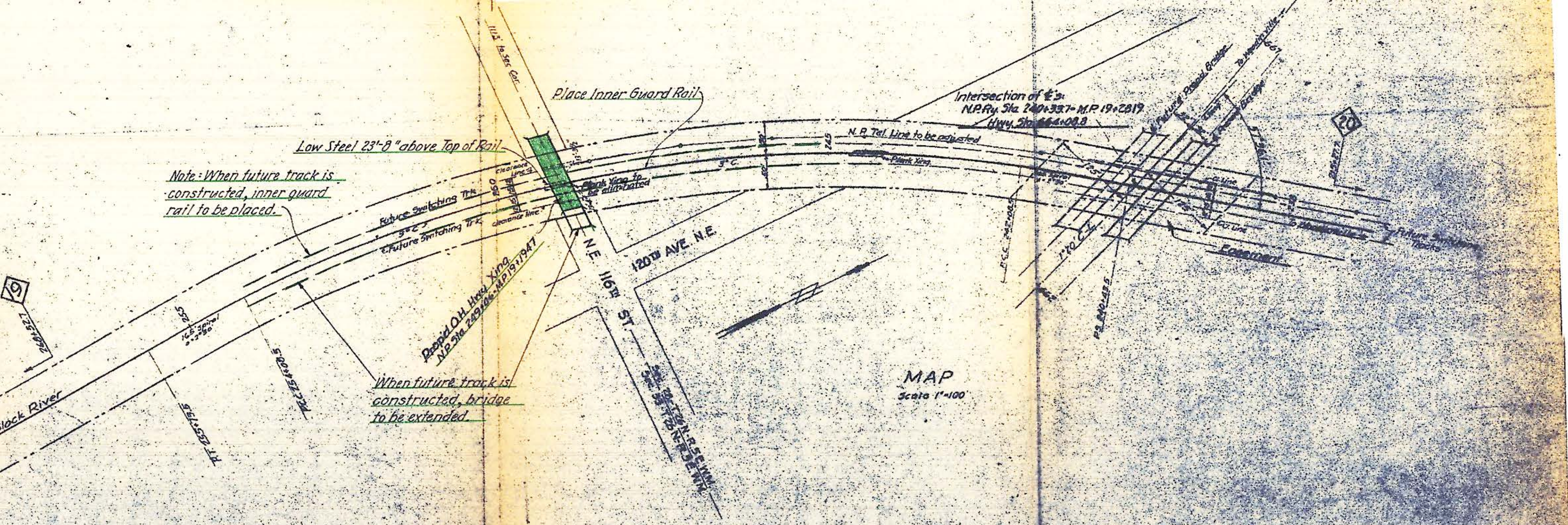

EXHIBIT "A"

N.P.Ry.  
Tacoma Div. 11th Sub - Lake Washington Dist Line  
**KIRKLAND**  
Prop'd Overhead Highway Xing  
at MP 19+281.9

Office Dist. Engr. Seattle, Wa.  
Scale 1"=100' Oct. 2, 1956  
Rev. May 3, 1957