



N. P. 1363

1-49

1968

NORTHERN PACIFIC RAILWAY COMPANY

AUTHORITY FOR EXPENDITURE

COMPTROLLER'S COPY

1968

1968

YEAR

SUPERINTENDENT'S R. F. A.

DEPT. No.

No.

ENGINEERING DEPT. No. 15

A. F. E. NO.

110

Tacoma

Div.

Lake Wash.
Belt LineDISTRICT
BRANCH

STATE

Wash.

VAL. SEC. No. 8-A

AUTHORITY IS REQUESTED FOR A NET EXPENDITURE OF \$ 16,080

2221-67

also 9083-68

Accounting distribution as follows: (Distribution to be made in General Office.)

	Operating Expenses	Net Operating Expenses
Cost of property retired.....\$		
Value of salvage		
Incidental costs		2000
Total to Operating Expenses		\$ 2000
Total to Accrued Depreciation	Acct. No. 735	4100
To Material and Supplies		575
To Bills for Collection		58285
To Other Accounts		
Net charge to investment account—Additions and Betterments		9980
Total of distribution		\$ 74940

Budget reference: Not in Budget

Class of Work: No. 7

Joint facility contract reference: Not Joint Account

The location is on this company's property. To secure rights, it will be necessary

Location: Between Houghton and Kirkland

Title Rebuild Bridge No.16

and

Reason: Agreement dated November 6, 1967, between the N.P. Ry. Co. and the Cities of Houghton and Kirkland, Washington, covers the reconstruction of the Railway Company's Bridge No. 16 which carries the Railway Company's Lake Washington Belt Line track over N. E. 68th Street at M.P. 16+1665 between the two cities.

Reconstruction of the bridge is necessary in connection with the widening and lowering of N. E. 68th Street.

The work will be carried out by the Railway Co. on the basis of the Railway Company bearing 25% of the cost and the two cities bearing the remaining 75%.



Work to be done by company force under charge of

Engineering Department

Accounting to concentrate in the office of

Manager Disbursement Accounting, St. Paul

Signature and Title:

Valuation Engineer

Date Jan. 29, 1968

16

426+80.3

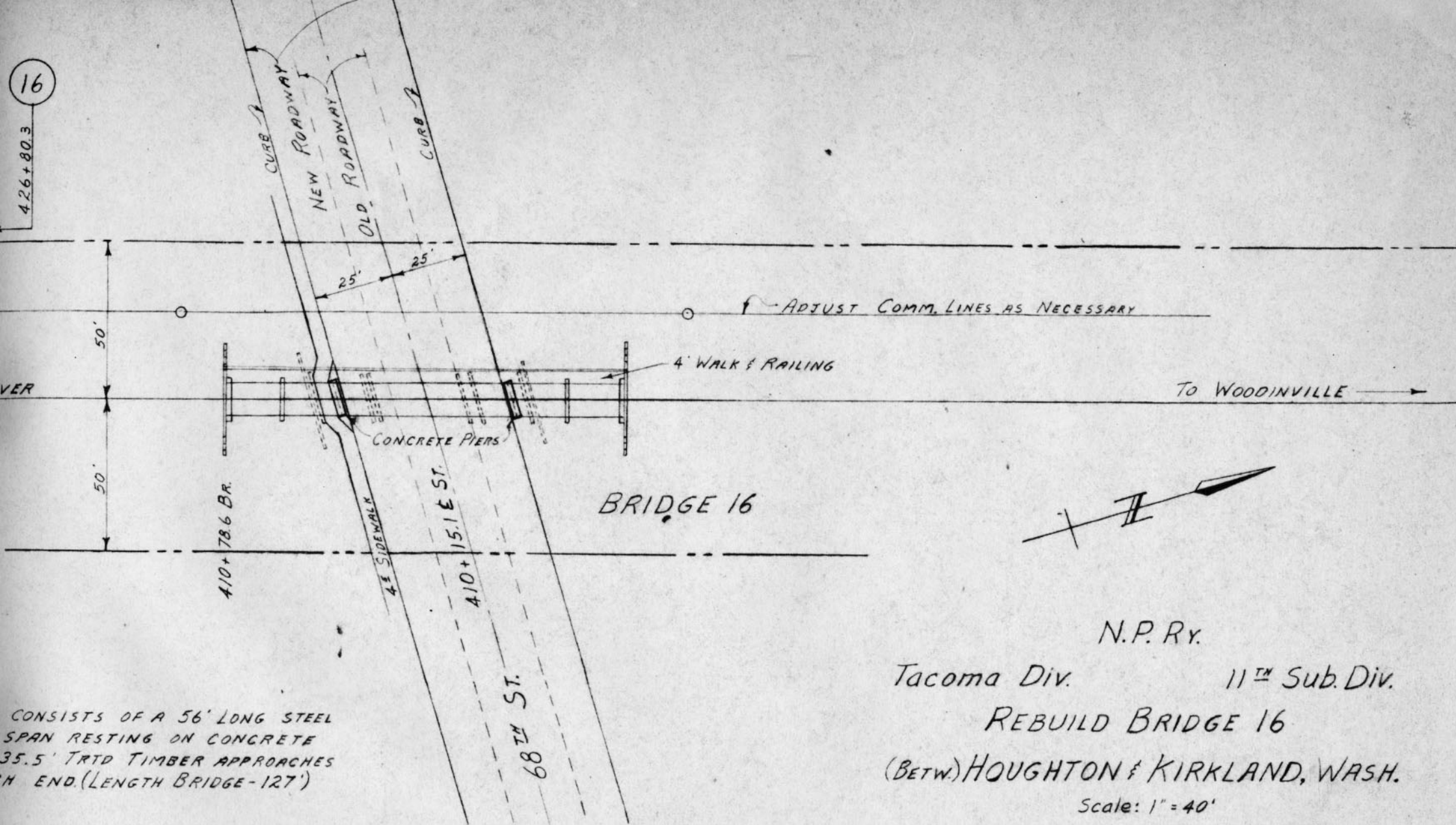

CONSISTS OF A 56' LONG STEEL
SPAN RESTING ON CONCRETE
35.5' TRID TIMBER APPROACHES
AT EACH END. (LENGTH BRIDGE - 127')

Tacoma Div. 11TH Sub. Div.
REBUILD BRIDGE 16
(BETW.) HOUGHTON & KIRKLAND, WASH.

Scale: 1" = 40'

Office of Chief Engr., St. Paul, Minn., Dec. 19, 1967

New Work

Shown: ———

Removals

" : - - - - -

VAL. SEC. WASH. 8A

NORTHERN PACIFIC RAILWAY COMPANY

Tacoma DivisionLake Washington Belt LineBetween Houghton & KirklandState of WashingtonValuation Section 8-A

Estimate of cost to reconstruct Bridge No. 16, which carries the Railway Company track over N. E. 68th Street at M.P. 16+1665, in connection with the widening and lowering of the street beneath the bridge per sketch dated December 19, 1967.

Proposed Work: By the N.P. Ry. Co. at the expense of the Railway Company and the Cities of Houghton and Kirkland.

- 1 - Design and prepare plans, preliminary field engineering, drafting, layout plans and estimates.
- 2 - Adjust communications poles and lines.
- 3 - Replace existing 69 Ft. long timber bridge with a 127 Ft. bridge consisting of a 56 Ft. long steel center span resting on concrete piers and 35.5 Ft. treated timber approaches at each end.
- 4 - Perform flagging and furnish protective services and devices during construction as deemed necessary by the Railway Company.

Additions and BettermentsAdditionsDepreciable PropertyAccount No. 39 - Highway Underpass

Design & prepare plans, etc.	3300	
Excavation, grading 600 cy	1200	
Excavation, structures 250 cy	1250	
Piling, treated 1700 LF	1700	2550
Piling, untr., falsework 400 LF	400	320
Drill holes for piling 300 LF	450	
Concrete and forms 110 cy	5500	3560
Reinforcing steel 5500 lbs.	440	440
Structural steel 80000 lbs.	3200	15200
Stringers & Caps, timber trtd. 15 MBM	2250	3150
Caps, timber, untr. falsework 1 MBM	150	160
Timber walk & bracing, trtd. 1.6 MBM	160	260
Timber bulkheads, treated 2.5 MBM	250	400
Metal decking 620 Sq. Ft.	125	290
Sheet metal 550 lbs.	110	80
Hardware 3000 lbs.	300	600
Pilot service	800	
Hauling and unloading	500	
Store and Purchase expense		675
Rent on equipment		4270
Engineering	2900	
	24985	31955
		24985
		56940
		42705
		14235

Less Houghton & Kirkland portion 75%
N.P. Ry. Co. portion 25%

709-17-01c

